



Santa Cruz

Building 1 | Level 1 - 4

Beds: 2

Baths: 2

Total Interior Sq Ft: 1177

Total Livable Sq Ft: 1281

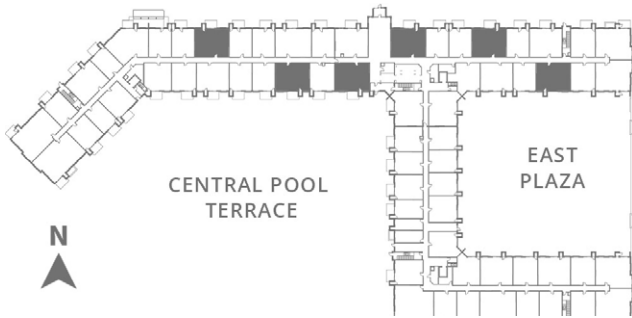

Leasing Office:

P: 763-453-7600

E: leasing@thereserveatarborlakes.com

11650 Arbor Lakes Parkway North,
Maple Grove, MN, 55369.
