



# Waterton

## Building 2 | Level 1

Beds: 2

Baths: 2

Total Interior Sq Ft: 1278

Total Livable Sq Ft: 1348

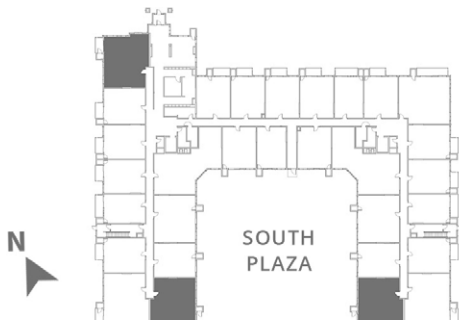

### Leasing Office:

P: 763-453-7600

E: leasing@thereserveatarborlakes.com

11650 Arbor Lakes Parkway North,  
Maple Grove, MN, 55369.

---

---

---

---

---

---

---

---