

C3

# LaPond

**Building 4 | Level 2 - 5**

Beds: 2

Baths: 2

Total Interior Sq Ft: 1403

Total Livable Sq Ft: 1473

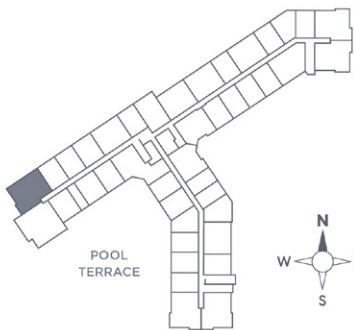

Apartment # \_\_\_\_\_

Cabinet Color: \_\_\_\_\_ Direction facing: \_\_\_\_\_

**Leasing:**

E: [leasing@thereserveatarborlakes.com](mailto:leasing@thereserveatarborlakes.com)

11650 Arbor Lakes Parkway North,  
Maple Grove, MN, 55369.