

Olympic

Building 2 | Level 2 - 4

Beds: 1

Baths: 1

Total Interior Sq Ft: 799

Total Livable Sq Ft: 869

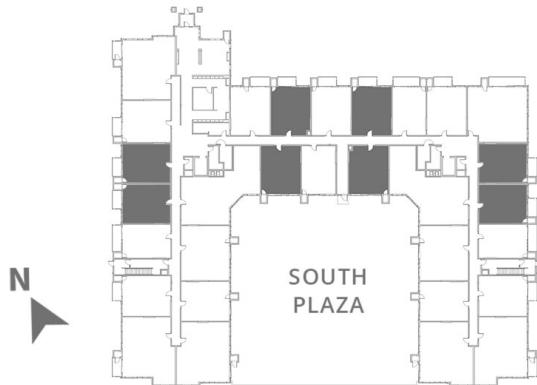

Leasing Office:

P: 763-453-7600

E: leasing@thereserveatarborlakes.com

11650 Arbor Lakes Parkway North,
Maple Grove, MN, 55369.

Apartment # _____

Cabinet Color: _____ Direction facing: _____

